

Reference : C-L20H30 8F-8H F-NB

The Fixolite box is a 6 m long prefabricated lintel box designed to receive a closure (roller shutter, BSO, etc.). The box consists of an inverted U-shaped, fire-retardant expanded polystyrene (30 kg/m³ density) shell reinforced with steel mesh. The side walls are fitted with aluminum rails.

Half-Lintel model box. This box is suitable for "block-bay" closures: one-piece systems which combine closure and shutter. The box is certified by Technical Advice to the CSTB.

Type	L20H30
Outer rail ref.	8F
Inner rail ref.	8H
Finishing	Wood-cement fiber
Color	Blue polystyrene
Compatible cheek	J-L20
Certification	CSTB 16-23-796 (translated)
Thermal conductivity	$U = W/m^2.K$
Thermal resistance*	$R = m^2.K/W$
(*) R: thermal resistance (m ² .K/W) taking into account a λ coefficient of 0.0374 W/m.K after application of a safety coefficient of 1.15.	
Weight	2.84 kg/m
Reaction to fire	class E (EN ISO 11925-2/EN 13 501)
Air permeability	c*3 class
Acoustic perf. (D _{nw})	-

Components

Aluminium (recycl. 85%)	0.58 kg/m
Steel (recycl. 96.5%)	0.61 kg/m
Polystyrene (recycl. 10%)	0.45 kg/m
Wood-cement fiber	1.2 kg/m
Total	2.84 kg/m

Finishing (Wood-cement fiber)**Box dimensions**

Width	200 mm
Height	300 mm
Tunnel	174 mm
External side	- mm
Internal side	26 mm

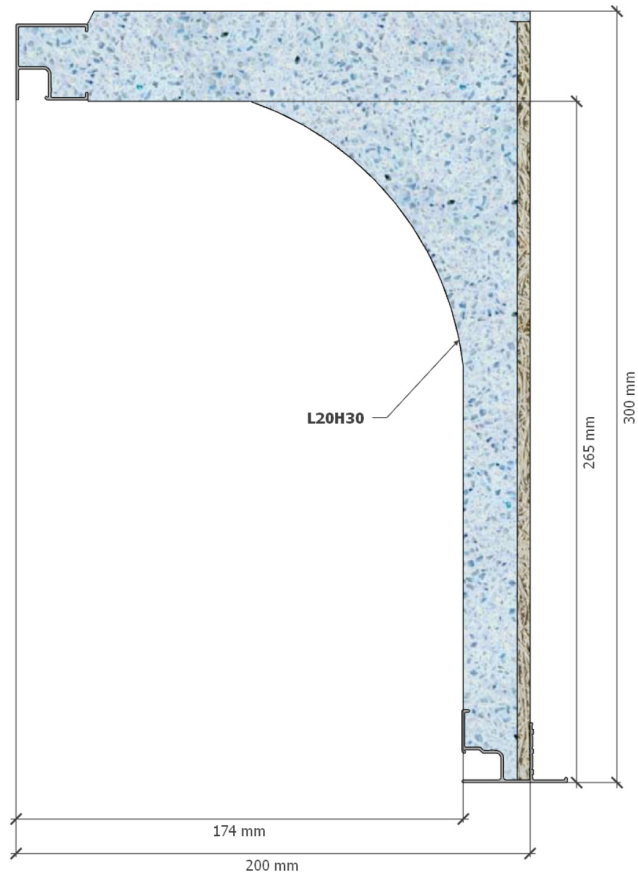

Box shown: C-L20H30 830-8H F-NB

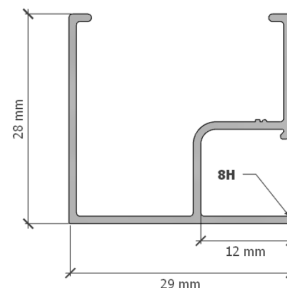
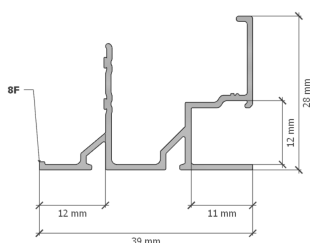
Rail diagram**English version:**
https://fixolite.eu/doc/C-L20H30_8F-8H_F-NB.en.pdf
**Version française:**
https://fixolite.eu/doc/C-L20H30_8F-8H_F-NB.fr.pdf