

Reference : C-28H30 8-8H TC

The Fixolite box is a 6 m long prefabricated lintel box designed to receive a closure (roller shutter, BSO, etc.). The box consists of an inverted U-shaped, fire-retardant expanded polystyrene (30 kg/m³ density) shell reinforced with steel mesh. The side walls are fitted with aluminum rails.

Traditional model box. This box is the most economical and offers good performance. The box is certified by Technical Advice to the CSTB.

Type	28H30
Outer rail ref.	827
Inner rail ref.	8H
Color	Blue polystyrene
Compatible cheek	J-28

Certification [CSTB 16-11-634 \(translated\)](#)

Thermal conductivity $U = 1.56 \text{ W/m}^2.\text{K}$

Thermal resistance* $R = 0.64 \text{ m}^2.\text{K/W}$

(*) R: thermal resistance (m².K/W) taking into account a λ coefficient of 0.0374 W/m.K after application of a safety coefficient of 1.15.

Weight 6.18 kg/m

Reaction to fire class E (EN ISO 11925-2/EN 13 501)

Air permeability c*3 class

Acoustic perf. (Dn_W) 49 dB

Box dimensions

Width	278 mm
Height	295 mm
Tunnel	230 mm
External side	24 mm
Internal side	24 mm

Components

Brick (terracotta)	4.2 kg/m
Aluminium (recycl. 85%)	0.56 kg/m
Steel (recycl. 96.5%)	0.76 kg/m
Polystyrene (recycl. 10%)	0.66 kg/m
Total	6.18 kg/m

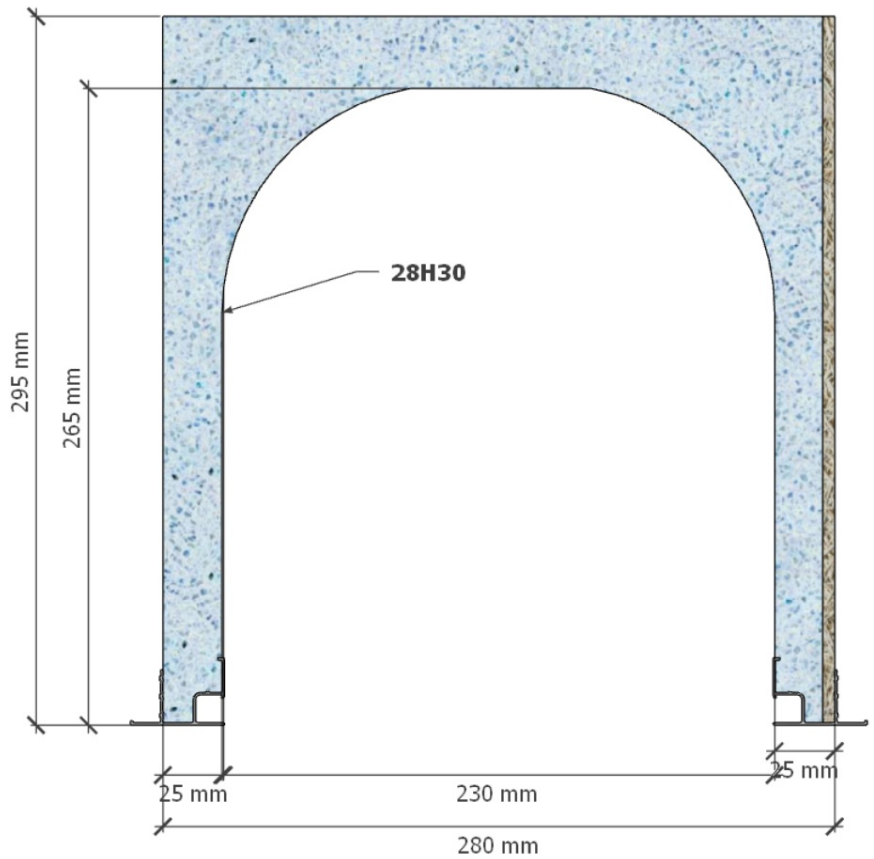

Box shown: C-28H30 8-8 F

Sides finishing

External side
Brick (terracotta)



Internal side
Ribbed polystyrene



Rail diagram

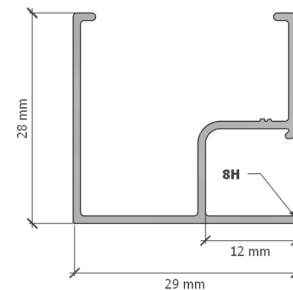
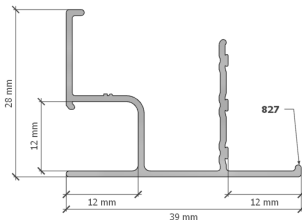

[English version](#) [Version française](#)

